

Installation & CARE

2012-2015 TOYOTA TACOMA PROJECTOR HEADLIGHTS INSTALLATION INSTRUCTIONS

BEFORE INSTALLATION:

- If you experience any difficulties that the instructions did not cover, please seek assistance at a local automotive shop.
- Please wear proper protective equipment before you work on any vehicle.
- An assistant is recommended when removing the front bumper from your vehicle.
- Please be cautious when working with the bumper or any parts belonging to the vehicle's body to prevent scratching.
- Do not make direct contact with the halogen bulbs or the wire assembly until the unit has cooled down after use.

TOOLS AND SUPPLIES REQUIRED

| | | | |
|--|---|---|---|
| ¼" Ratchet | Phillips Screwdriver | 10 mm socket | Flathead screwdriver |
|  |  |  |  |
| Trim Pad Remover | Plastic Pry bar | | |
|  |  | | |
| | | | |
| | | | |
| | | | |

PRODUCT NUMBER

2LHP-TAC12-TM 2LHP-TAC12BK-TM
2LHP-TAC12JM-TM 2LHP-TAC12G-TM



LET'S START THE INSTALLATION



STEP 1

Remove the two plastic retainers and two 10mm bolts

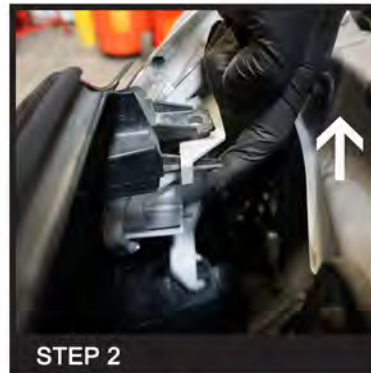

STEP 2

Unseat the front grille



STEP 3

Unseat the front grille



STEP 4A

Remove the headlight filler trim panel

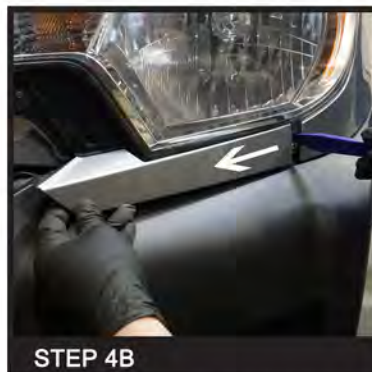

STEP 4B

Remove the headlight filler trim panel

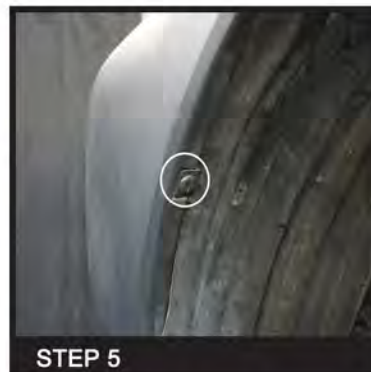

STEP 5

Remove the plastic retainer

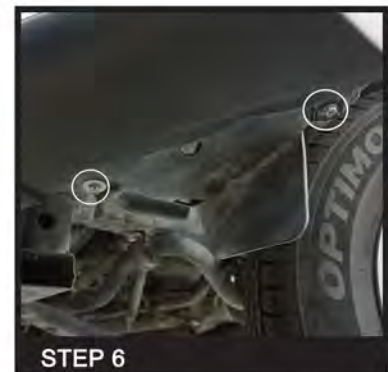

STEP 6

Remove the two 10mm bolts



STEP 7

Pull out the fender wheel well liner



STEP 8

Remove the 10mm nut behind the fender wheel well



STEP 9

Remove the two 10mm headlight bolts at the top



STEP 10

Use the flat head screwdriver to unseat the factory headlight housing



STEP 11

Remove the factory headlight housing

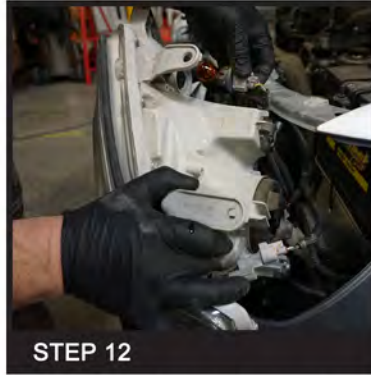

STEP 12

Disconnect the headlight harness from the factory headlight housing

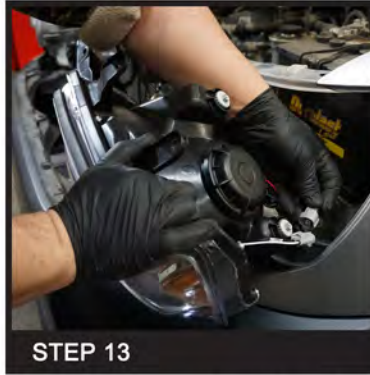

STEP 13

Connect the headlight harness to the new headlight housing

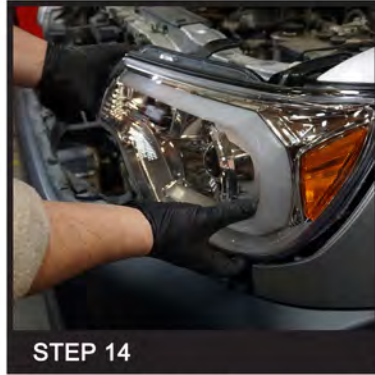

STEP 14

Seat the new headlight assembly in place



STEP 15

Reinstall the two 10mm headlight mounting bolts at the top



STEP 16

Reinstall the 10mm nut behind the fender wheel well

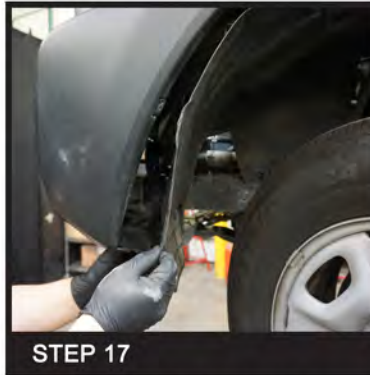

STEP 17

Reinstall the fender wheel well liner



STEP 18

Reinstall the two 10mm bolts



STEP 19A

Reinstall the plastic retainer



STEP 19B

Reinstall the headlight filler trim panel

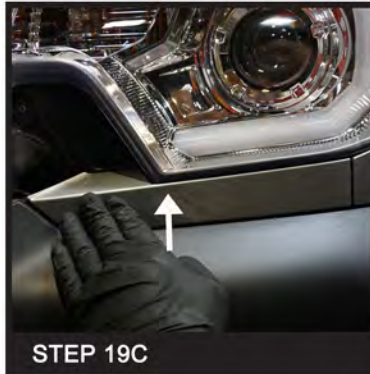

STEP 19C

Reinstall the headlight filler trim panel



STEP 20

Please repeat the steps from 4A to 19C for the opposite side



STEP 21

Reinstall the front grille



STEP 22

Reinstall the two plastic retainers and the two 10mm bolts



STEP 23

Close the hood and complete the installation

Installation & CARE

2012-2015 TOYOTA TACOMA PROJECTOR HEADLIGHTS INSTALLATION INSTRUCTIONS

BEFORE INSTALLATION:

- If you experience any difficulties that the instructions did not cover, please seek assistance at a local automotive shop.
- Please wear proper protective equipment before you work on any vehicle.
- An assistant is recommended when removing the front bumper from your vehicle.
- Please be cautious when working with the bumper or any parts belonging to the vehicle's body to prevent scratching.
- Do not make direct contact with the halogen bulbs or the wire assembly until the unit has cooled down after use.

2012-2015 TOYOTA TACOMA PROJECTOR HEADLIGHTS INSTALLATION INSTRUCTIONS



- **HIGH / LOW BEAM**
Adjustment Screws